

---

# Globe Valves

- Forged Steel Globe Valves
- Cast Steel Globe Valves

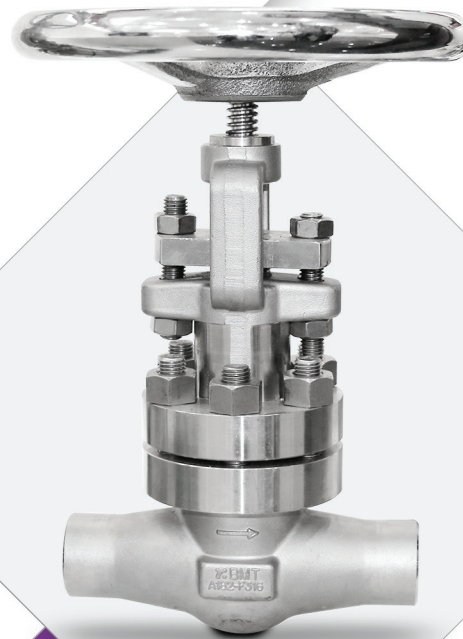

# Forged Steel Globe Valves

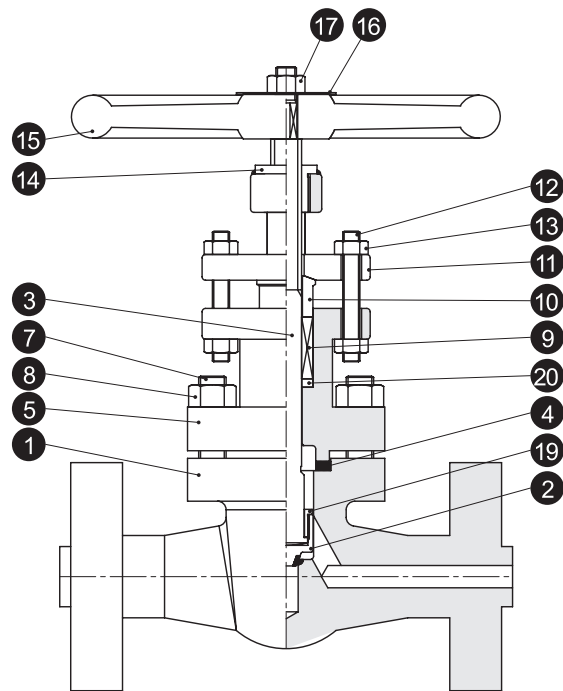

## Features

- Forged steel, outside screw and yoke (OS & Y)
- Rotating rising stem, rising handwheel.
- Full or conventional port.
- Bolted bonnet joint.
- Integral backseat, Integral body seat.
- Sizes: 1/2 to 6 in.
- Classes: CL150 to CL2500

## Specifications

- Design: ASME B16.34 / BS1873
- Face to Face: ASME B16.10
- End Flange: ASME B16.5
- Thread/Socket End: ASME B1.20.1 / B16.11
- Test: API 598

## Materials of Construction

| No. | COMPONENT     | BODY MATERIAL    |                 |
|-----|---------------|------------------|-----------------|
|     |               | Stainless Steel  | Carbon Steel    |
| 1   | BODY          | A182 F316 (+ HF) | A105 (+ HF)     |
| 2   | DISC          | A276 316 (+ HF)  | A276 410 (+ HF) |
| 3   | STEM          | A276 316         | A276 410        |
| 4   | GASKET        | 316 / GRAPHITE   | 316 / GRAPHITE  |
| 5   | BONNET        | A182 F316        | A105            |
| 7   | BONNET BOLT   | A193 B8M         | A193 B7         |
| 8   | BONNET NUT    | A194 8M          | A194 2H         |
| 9   | PACKING       | GRAPHITE         | GRAPHITE        |
| 10  | PACKING GLAND | A276 316         | A276 410        |
| 11  | GLAND FLANGE  | A276 316         | A276 410        |
| 12  | GLAND BOLT    | A193 B8M         | A193 B7         |
| 13  | GLAND NUT     | A194 8M          | A194 2H         |
| 14  | YOKE SLEEVE   | A276 316         | A276 410        |
| 15  | HANDWHEEL     | A47              | A47             |
| 16  | NAME PLATE    | STAINLESS STEEL  | STAINLESS STEEL |
| 17  | WHEEL NUT     | A194 8           | A307 B          |
| 19  | DISC NUT      | A276 316         | A276 410        |
| 20  | SUPPORT RING  | A276 316         | A276 410        |

## Table of Dimensions

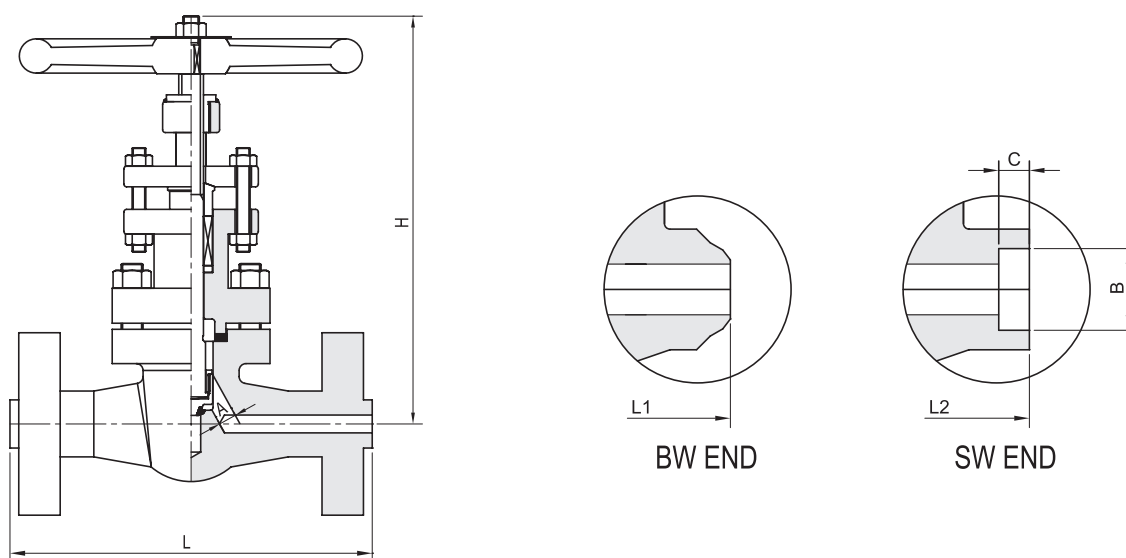

### Class 150

| Size (Inch) | L Face To Face | L1 End To End | L2 Socket Weld | A Port | H Center to Top Open | W Handwheel | B Socket Weld Bore | C Socket Weld Depth |
|-------------|----------------|---------------|----------------|--------|----------------------|-------------|--------------------|---------------------|
| 1/2         | 108            | 108           | 79             | 13     | 220                  | 100         | 21.42              | 10                  |
| 3/4         | 117            | 117           | 92             | 19     | 220                  | 100         | 27.05              | 13                  |
| 1           | 127            | 127           | 111            | 25     | 260                  | 125         | 33.78              | 13                  |
| 1-1/4       | 140            | 140           | 152            | 32     | 355                  | 160         | 42.55              | 13                  |
| 1-1/2       | 165            | 165           | 152            | 38     | 355                  | 160         | 48.64              | 13                  |
| 2           | 178            | 216           | 172            | 49     | 355                  | 180         | 61.11              | 16                  |
| 2-1/2       | 190            | 241           | -              | 62     | 370                  | 224         | -                  | -                   |
| 3           | 203            | 282           | -              | 74     | 400                  | 224         | -                  | -                   |
| 4           | 229            | 305           | -              | 100    | 480                  | 224         | -                  | -                   |
| 6           | 267            | 403           | -              | 150    | 600                  | 300         | -                  | -                   |

### Class 300

| Size (Inch) | L Face To Face | L1 End To End | L2 Socket Weld | A Port | H Center to Top Open | W Handwheel | B Socket Weld Bore | C Socket Weld Depth |
|-------------|----------------|---------------|----------------|--------|----------------------|-------------|--------------------|---------------------|
| 1/2         | 140            | 140           | 79             | 13     | 220                  | 100         | 21.72              | 10                  |
| 3/4         | 152            | 152           | 92             | 19     | 220                  | 100         | 27.05              | 13                  |
| 1           | 165            | 165           | 111            | 25     | 260                  | 125         | 33.78              | 13                  |
| 1-1/4       | 178            | 178           | 152            | 32     | 355                  | 160         | 42.55              | 13                  |
| 1-1/2       | 190            | 190           | 152            | 38     | 355                  | 160         | 48.64              | 13                  |
| 2           | 216            | 216           | 172            | 49     | 355                  | 180         | 61.11              | 16                  |
| 2-1/2       | 241            | 241           | -              | 62     | 400                  | 224         | -                  | -                   |
| 3           | 282            | 282           | -              | 74     | 440                  | 224         | -                  | -                   |
| 4           | 305            | 305           | -              | 100    | 500                  | 224         | -                  | -                   |
| 6           | 403            | 403           | -              | 150    | 600                  | 300         | -                  | -                   |

- Dimensions and Drawings are for reference only and are subject to change without prior notice.

- Unless otherwise specified, all dimensions are in millimeters.

- Sizes, pressure classes, and end connections not listed are available upon request.

## Table of Dimensions

### Class 600

| Size (Inch) | L Face To Face | L1 End To End | L2 Socket Weld | A Port | H Center to Top Open | W Handwheel | B Socket Weld Bore | C Socket Weld Depth |
|-------------|----------------|---------------|----------------|--------|----------------------|-------------|--------------------|---------------------|
| 1/2         | 140            | 140           | 79             | 13     | 220                  | 100         | 21.72              | 10                  |
| 3/4         | 152            | 152           | 92             | 19     | 220                  | 100         | 27.05              | 13                  |
| 1           | 165            | 165           | 111            | 25     | 260                  | 125         | 33.78              | 13                  |
| 1-1/4       | 178            | 178           | 152            | 32     | 355                  | 160         | 42.55              | 13                  |
| 1-1/2       | 190            | 190           | 152            | 38     | 355                  | 160         | 48.64              | 13                  |
| 2           | 216            | 216           | 172            | 49     | 355                  | 180         | 61.11              | 16                  |
| 2-1/2       | 241            | 241           | -              | 62     | 400                  | 224         | -                  | -                   |
| 3           | 282            | 282           | -              | 74     | 440                  | 224         | -                  | -                   |
| 4           | 305            | 305           | -              | 100    | 500                  | 224         | -                  | -                   |
| 6           | 403            | 403           | -              | 150    | 600                  | 300         | -                  | -                   |

### Class 900 / 1500

| Size (Inch) | L Face To Face | L1 End To End | L2 Socket Weld | A Port | H Center to Top Open | W Handwheel | B Socket Weld Bore | C Socket Weld Depth |
|-------------|----------------|---------------|----------------|--------|----------------------|-------------|--------------------|---------------------|
| 1/2         | -              | -             | 111            | 13     | 280                  | 170         | 21.72              | 10                  |
| 3/4         | -              | -             | 111            | 19     | 284                  | 170         | 27.05              | 13                  |
| 1           | 254            | 254           | 120            | 25     | 345                  | 250         | 33.78              | 13                  |
| 1-1/4       | 279            | 279           | 140            | 32     | 360                  | 250         | 42.55              | 13                  |
| 1-1/2       | 305            | 305           | 140            | 38     | 400                  | 250         | 48.64              | 13                  |
| 2           | 368            | 368           | 144            | 49     | 520                  | 350         | 61.11              | 16                  |

### Class 2500

| Size (Inch) | L Face To Face | L1 End To End | L2 Socket Weld | A Port | H Center to Top Open | W Handwheel | B Socket Weld Bore | C Socket Weld Depth |
|-------------|----------------|---------------|----------------|--------|----------------------|-------------|--------------------|---------------------|
| 1/2         | 264            | 264           | 264            | 13     | 320                  | 250         | 21.72              | 10                  |
| 3/4         | 273            | 273           | 273            | 19     | 336                  | 250         | 27.05              | 13                  |
| 1           | 308            | 308           | 308            | 25     | 390                  | 250         | 33.78              | 13                  |
| 1-1/4       | 349            | 349           | 349            | 32     | 420                  | 400         | 42.55              | 13                  |
| 1-1/2       | 384            | 384           | 384            | 38     | 520                  | 400         | 48.64              | 13                  |
| 2           | 451            | 451           | 451            | 42     | 555                  | 400         | 61.11              | 16                  |

- Dimensions and Drawings are for reference only and are subject to change without prior notice.

- Unless otherwise specified, all dimensions are in millimeters.

- Sizes, pressure classes, and end connections not listed are available upon request.

# Cast Steel Globe Valves

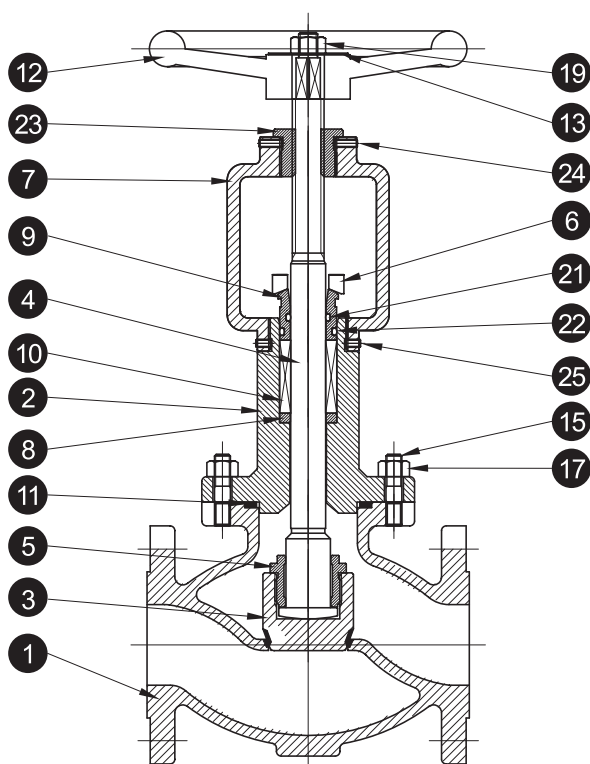

## Features

- Bolted bonnet, OS&Y, Swivel Disc.
- Plug type disc
- On smaller size, the yoke is cast integral with bonnet. Larger sizes have two piece yoke, refer to individual drawing.
- Stem nut is mounted with ball bearings to reduce operating torque for ease of manual operation in larger sizes and higher classes.
- Sizes: 2 to 16 in.
- Classes : CL150 to CL1500

## Specifications

- Design: ASME B16.34/BS1873
- Face to Face: ASME B16.10
- End Flange: ASME B16.5
- BW End: ASME B16.25
- Test: API 598

## Materials of Construction

| No. | COMPONENT           | MATERIAL        |
|-----|---------------------|-----------------|
| 1   | BODY                | A351-CF8M       |
| 2   | EXTENSION BONNET    | A351-CF8M       |
| 3   | DISC                | A276-316        |
| 4   | EXTENSION STEM      | A276-316        |
| 5   | DISC NUT            | A276-316        |
| 6   | GLAND FLANGE        | A240-304        |
| 7   | YOKE                | A351-CF8M       |
| 8   | STEM WASHER         | A276-316        |
| 9   | PACKING GLAND       | A276-316        |
| 10  | PACKING             | GRAPHITE+WIRE   |
| 11  | SPIRAL WOUND GASKET | GRAPHITE+316SS  |
| 12  | HANDLE              | FC20            |
| 13  | HANDLE NAMEPLATE    | STAINLESS STEEL |
| 14  | NAMEPLATE           | STAINLESS STEEL |
| 15  | BODY BOLT           | A193-B8M-CL.2   |
| 16  | HEX SOCKET BOLT     | 304 SS          |
| 17  | HEAVY HEX NUT       | A194-8M         |
| 18  | HEX NUT             | 304 SS          |
| 19  | HEX NUT             | 304 SS          |
| 20  | PACKING BOLT        | 304 SS          |
| 21  | O-RING              | NBR             |
| 22  | O-RING              | NBR             |
| 23  | YOKE BUSHING        | BRASS           |
| 24  | SET SCREW           | 304 SS          |
| 25  | SET SCREW           | 304 SS          |

## Table of Dimensions

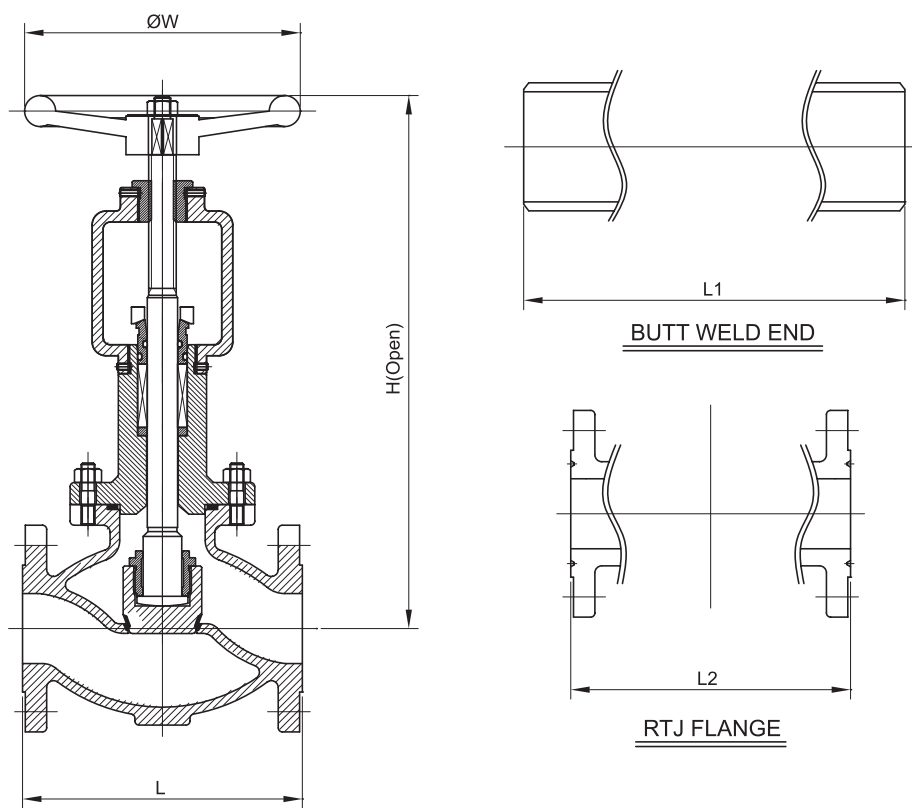

### Class 150

| Size |     | L & L1 | L2  | H    | ØW  | Wt.(kg) |      |
|------|-----|--------|-----|------|-----|---------|------|
| Inch | DN  |        |     |      |     | B,W     | RF   |
| 2    | 50  | 203    | 216 | 390  | 200 | 14      | 17   |
| 2.5  | 65  | 216    | 229 | 390  | 224 | 23      | 25   |
| 3    | 80  | 241    | 254 | 435  | 224 | 29      | 34   |
| 4    | 100 | 292    | 305 | 505  | 250 | 48      | 53   |
| 6    | 150 | 406    | 419 | 585  | 355 | 90      | 108  |
| 8    | 200 | 495    | 508 | 720  | 355 | 191     | 209  |
| 10   | 250 | 622    | 636 | 800  | 450 | 312     | 300  |
| 12   | 300 | 699    | 711 | 1010 | 500 | 472     | 510  |
| 14   | 350 | 787    | 800 | 1350 | 710 | 666     | 768  |
| 16   | 400 | 914    | 927 | 1440 | 900 | 900     | 1022 |

### Class 300

| Size |     | L & L1 | L2  | H    | ØW  | Wt.(kg) |      |
|------|-----|--------|-----|------|-----|---------|------|
| Inch | DN  |        |     |      |     | B,W     | RF   |
| 2    | 50  | 267    | 283 | 395  | 200 | 20      | 24   |
| 2.5  | 65  | 292    | 308 | 430  | 224 | 40      | 46   |
| 3    | 80  | 318    | 333 | 465  | 250 | 47      | 46   |
| 4    | 100 | 356    | 371 | 555  | 355 | 54      | 71   |
| 6    | 150 | 444    | 460 | 750  | 450 | 149     | 173  |
| 8    | 200 | 559    | 575 | 810  | 560 | 269     | 306  |
| 10   | 250 | 622    | 638 | 1180 | 710 | 306     | 533  |
| 12   | 300 | 711    | 727 | 1290 | 710 | 473     | 701  |
| 14   | 350 | 838    | 854 | 1590 | 900 | 641     | 955  |
| 16   | 400 | 914    | 929 | 1635 | 900 | 895     | 1182 |

### Class 600

| Size |     | L & L1 | L2  | H    | ØW   | Wt.(kg) |      |
|------|-----|--------|-----|------|------|---------|------|
| Inch | DN  |        |     |      |      | B,W     | RF   |
| 2    | 50  | 292    | 929 | 430  | 224  | 36      | 42   |
| 2.5  | 65  | 330    | 333 | 430  | 224  | 50      | 65   |
| 3    | 80  | 356    | 359 | 530  | 280  | 61      | 76   |
| 4    | 100 | 432    | 435 | 600  | 355  | 106     | 144  |
| 6    | 150 | 559    | 562 | 800  | 450  | 252     | 322  |
| 8    | 200 | 660    | 664 | 1310 | 800  | 451     | 535  |
| 10   | 250 | 787    | 791 | 1700 | 1000 | 708     | 817  |
| 12   | 300 | 838    | 841 | 1845 | 1000 | 943     | 1074 |
| 14   | 350 | 889    | 892 | 1845 | 1000 | 1260    | 1406 |
| 16   | 400 | 991    | 994 | 1900 | 1000 | 2680    | 2880 |

### Class 900

| Size |     | L & L1 | L2   | H    | ØW  | Wt.(kg) |      |
|------|-----|--------|------|------|-----|---------|------|
| Inch | DN  |        |      |      |     | B,W     | RF   |
| 2    | 50  | 368    | 371  | 690  | 400 | 70      | 92   |
| 2.5  | 65  | 419    | 422  | 690  | 400 | 74      | 109  |
| 3    | 80  | 381    | 384  | 770  | 400 | 96      | 122  |
| 4    | 100 | 457    | 460  | 880  | 400 | 156     | 222  |
| 6    | 150 | 610    | 613  | 1370 | 710 | 281     | 434  |
| 8    | 200 | 737    | 740  | 1720 | 900 | 593     | 806  |
| 10   | 250 | 838    | 841  | 1765 | 900 | 1496    | 1640 |
| 12   | 300 | 965    | 965  | 1765 | 900 | 1920    | 2120 |
| 14   | 350 | 1029   | 1029 | 2210 | 900 | 2680    | 2920 |
| 16   | 400 | 1130   | 1130 | 2620 | 900 | 3120    | 3440 |

- Dimensions and Drawings are for reference only and are subject to change without prior notice.

- Unless otherwise specified, all dimensions are in millimeters.

- Sizes, pressure classes, and end connections not listed are available upon request.

## Table of Dimensions

### Class 1500

| Size |     | L & L1 | L2   | H    | ØW  | Wt.(kg) |      |
|------|-----|--------|------|------|-----|---------|------|
| Inch | DN  |        |      |      |     | B,W     | RF   |
| 2    | 50  | 368    | 371  | 690  | 400 | 400     | 92   |
| 2.5  | 65  | 419    | 422  | 690  | 400 | 400     | 134  |
| 3    | 80  | 470    | 473  | 800  | 500 | 500     | 175  |
| 4    | 100 | 546    | 549  | 1015 | 500 | 500     | 334  |
| 6    | 150 | 705    | 711  | 1345 | 900 | 900     | 672  |
| 8    | 200 | 832    | 841  | 1960 | 710 | 710     | 1424 |
| 10   | 250 | 991    | 1000 | 2310 | 760 | 760     | 3200 |
| 12   | 300 | 1130   | 1146 | 2670 | 760 | 760     | 4400 |
| 14   | 350 | 1257   | 1276 | 3200 | 760 | 760     | 5400 |
| 16   | 400 | 1384   | 1407 | 4064 | 760 | 760     | 6700 |

## Ordering Information

Example 1 : **F G B C 8 S R F 2 - 16 - 36 L**  
2      3      3      4      5      7

Example 2 : **F G B C A R F 1 - 32 - H - 34 L**  
1    2    3    4    5    6    7

### 1. Metal Forming Process

- (Blank) = Forging
- C = Casting

### 2. Pressure Rating

- A = CL 150
- B = CL 300
- C = CL 600
- D = CL 900
- E = CL 1500
- F = CL 2500

### 3. End Connection

| Flange     | Raised Face |          | Ring Joint |            | Flat Face |         |
|------------|-------------|----------|------------|------------|-----------|---------|
| Designator | RF          |          | RJ         |            | FF        |         |
| Butt Weld  | Sch 10S     | Sch 20S  | Sch 40S    | Sch 80S    | Sch 160S  | Sch XXS |
| Designator | 1S          | 2S       | 4S         | 8S         | 16        | DS      |
| Type       | Socket Weld | Male NPT | Male PT    | Female NPT | Female PT |         |
| Designator | SW          | MN       | MR         | FN         | FR        |         |

### 4. Bore

- 1 = Full Bore
- 2 = Reduced Bore

### 5. Size

| Size (in.) | 1/2 | 3/4 | 1  | 1-1/4 | 1-1/2 | 2  | 2-1/2 | 3  | 4  | 5  | 6  | 8   | 10  | 12  | 14  | 16  |
|------------|-----|-----|----|-------|-------|----|-------|----|----|----|----|-----|-----|-----|-----|-----|
| Designator | 8   | 12  | 18 | 20    | 24    | 32 | 40    | 48 | 64 | 80 | 96 | 128 | 160 | 192 | 224 | 256 |

### 6. Option

- H = Handle
- G = Gear Actuated
- M = Motor Operated

### 7. Material

- (Blank) = A182-F316 / A351-CF8M
- 36L = A182-F316L / A351-CF3M
- 304 = A182-F304 / A351-CF8
- 34L = A182-F304L / A351-CF3

※ For special sizes and configurations, please consult BMT (SUPERLOK) sales representative.

# BMT Co., Ltd.

## Headquarters

(46031) 부산시 기장군 장안읍 신소재산단2로 17 (반룡리)

17, Sinsojaesandan 2-ro, Jangan-eup, Gijang-gun, Busan, 46031 South Korea

TEL: +82 51 780 5000 FAX: +82 51 780 5100

E-mail: [superlok@superlok.com](mailto:superlok@superlok.com)

WEB: [www.superlok.com](http://www.superlok.com)

## Fittings & Valves

### Industrial

Instrumentation Tube Fittings

i-Fitting®

Ball/Plug Valves

Double Block & Bleed Valves

Manifold/Gauge Valves

Globe/Needle Valves

Cryogenic Valves

Check/Relief/Excess Flow Valves

Medium/High Pressure Fittings & Valves

Eco-fuel Conversion and Supply Units

### Ultra High Purity

HGS® (High-integrated Gas System)

Weld & Metal Face Seal Fittings

Bend Fittings

Diaphragm Valves

Bellows Valves

Check Valves

Clean Ball Valves

Regulators

Gas Filters

HGS® : Trademark registered in Republic of Korea (as of April 2024)

## Electric & Energy

Metal Clad Switchgear (MCSG)

Compact Switchboard

Motor Control Center (MCC)

Smart Distribution Board

Energy Management System (EMS)