

Ultra High Purity

# HGS<sup>®</sup> (High-integrated Gas System)

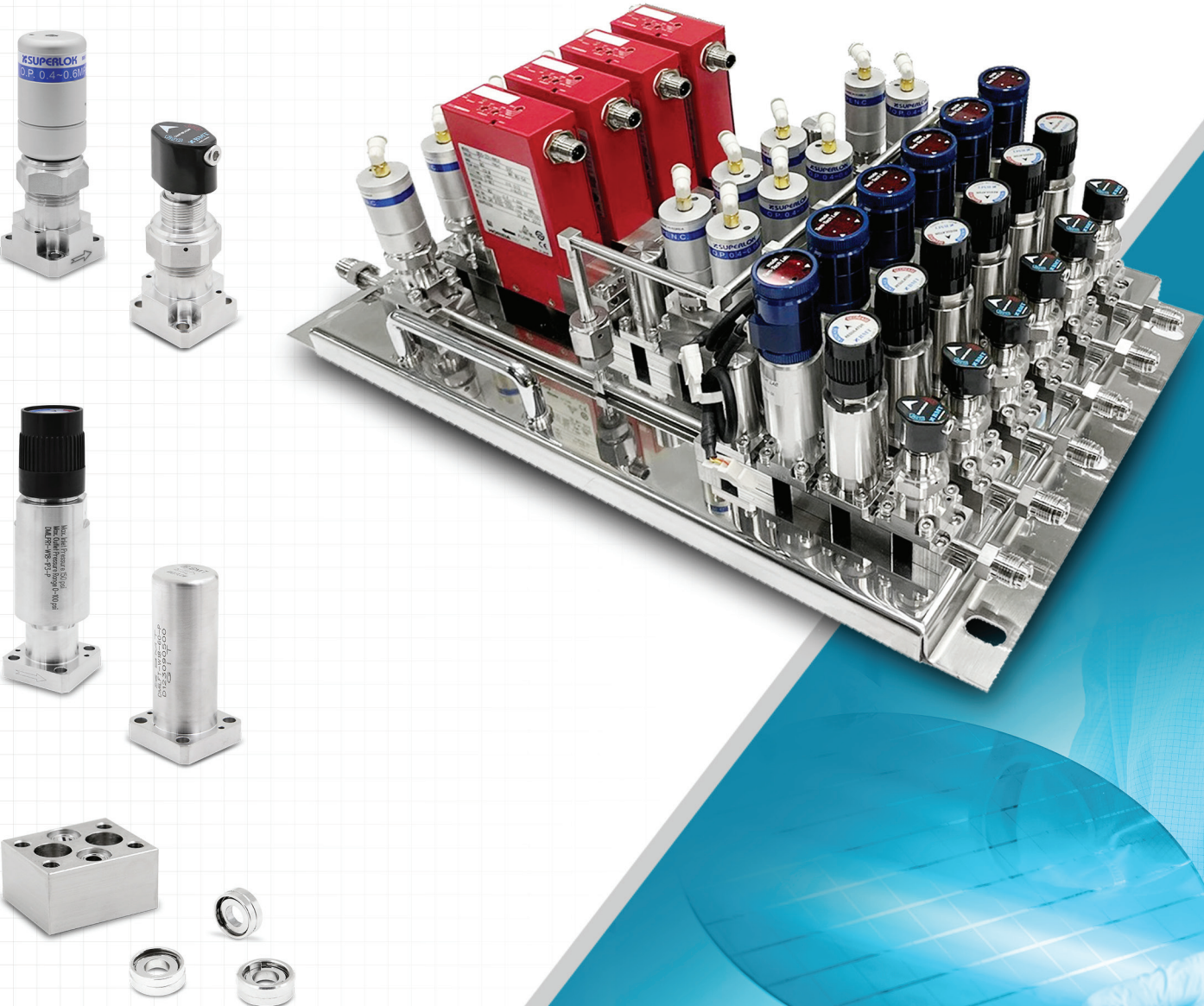

## Contents

<b>04</b>	<b>HGS® (High-integrated Gas System)</b>
	HGS® Valve
<b>05</b>	HGSODV1 - Low Pressure Manual Diaphragm Valves (Shutoff Type)
<b>07</b>	HGPDV1 - Low Pressure Pneumatic Diaphragm Valves
<b>09</b>	HGPBDV1 - Low Pressure Pneumatic Diaphragm Valves (Block)
	HGS® Check Valve
<b>11</b>	HGCVSE - Check Valves (Seal Type)
<b>12</b>	HGCVSP - Check Valves (Spring Type)
<b>13</b>	<b>HGS® Regulator</b>
<b>14</b>	HGPR1 - Regulators (Standard Type)
<b>16</b>	HGPRL1 - Regulators (Tied Type)
<b>18</b>	<b>HGS® Filter</b>
<b>19</b>	HGFT1 - Filters
<b>21</b>	HGFT2 - Filters
<b>23</b>	<b>HGS® Base Block &amp; Gasket</b>
<b>24</b>	Base Block - V-Type, WL-Type, L-Type
<b>25</b>	Gasket

HGS® : Trademark registered in Republic of Korea and Japan (as of January 2025)

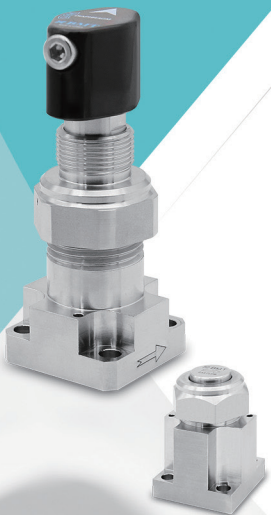

# BMT HGS CONFIGURATION

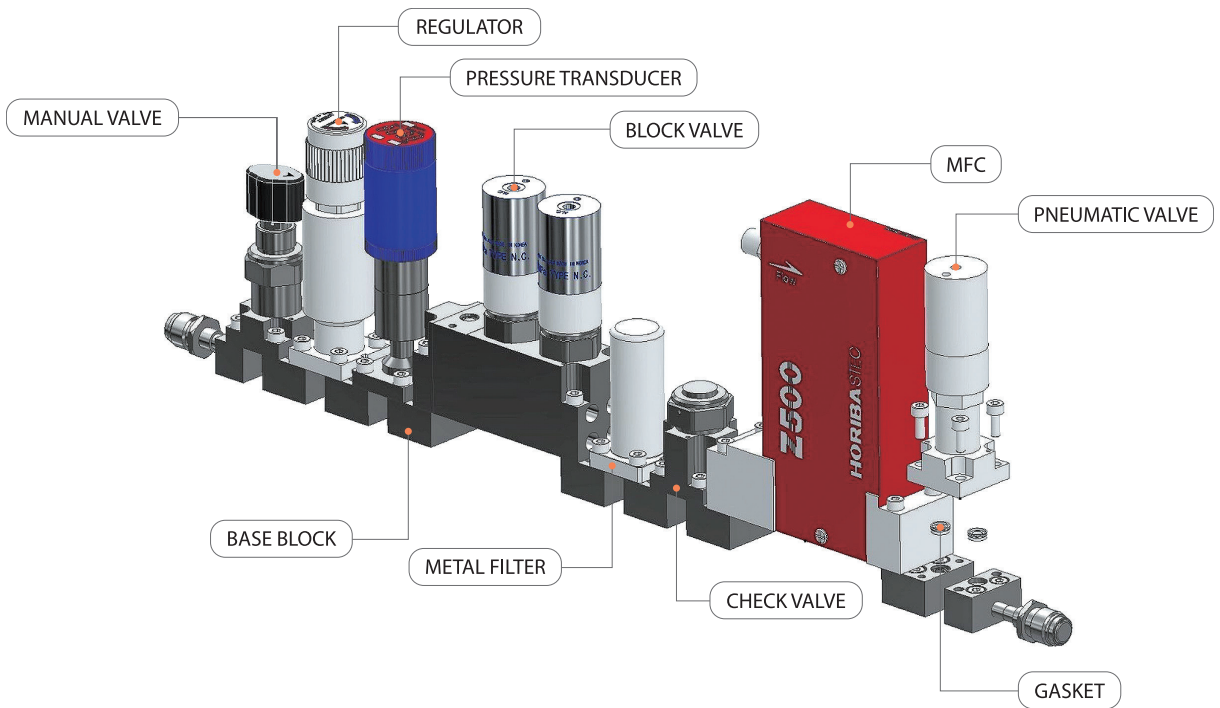

# BMT HGS COMPONENTS

			
<b>MANUAL VALVE</b> HGSODV1	<b>PNEUMATIC VALVE</b> HGPLV1	<b>BLOCK VALVE</b> HGPBDV1	<b>CHECK VALVE</b> HGCSE / HGCVSP
			
<b>REGULATOR</b> HGPR1 / HGPR1	<b>METAL FILTER</b> HGFT1 / HGFT2	<b>BASE BLOCK</b>	<b>GASKET</b>

# HGS® Valves

## Ordering Information

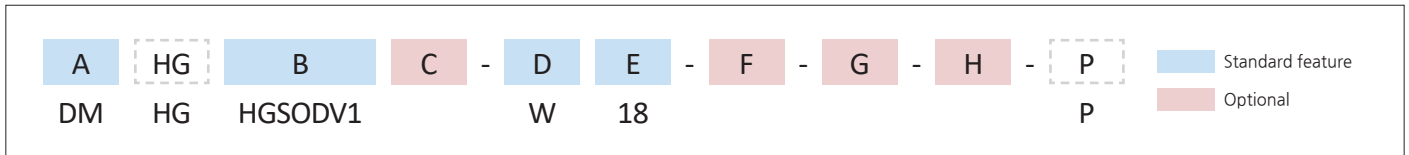

A	Materials	
	DM	316L Stainless Steel VAR

B	Product Series	
	HGSODV1	Manual Diaphragm Valve (Shutoff Type)
	HGPDV1	Pneumatic Diaphragm Valve
	HGPBDV1	Pneumatic Diaphragm Valve (Block Type)
	HGCVSE	Check Valve (Seal Type)
	HGCVSP	Check Valve (Spring Type)

C	Operation Method (for Pneumatic Valves)	
	Add an operation method designator for <a href="#">Pneumatic Valves</a> .	
	C	Normally Closed
	O	Normally Open

D	Connection Type	
	W	W-Seal

E	Body Size	
	Designator	Nominal Size
	18	1.125"
	24	1.5"

F	Flow Path (for Block Diaphragm Valves)	
	Add a Flow Path designator for <a href="#">Block Diaphragm Valves</a> .	
	1F23	1F23

G	Seat Material	
	PCTFE for Diaphragm Valves, RUBBER for Check Valves. No part designator are needed.	
	Blank	PCTFE
	PA	PFA
	For Diaphragm Valves	
	Blank	RUBBER
	F	FKM
	FF	FFKM
	For Check Valves	

H	Flow Rate	
	Cv 0.1 is standard. No part designator needed.	
	F	High Flow Type (Cv 0.2)

## Part Number Examples

	DMHGSODV1-W18-P		DMHGCVSE-W18-P	
Material	DM	316L Stainless Steel VAR	DM	316L Stainless Steel VAR
Product Series	HGSODV1	HGSODV1 series	HGCVSE	HGCVSE series
Operation Method		<i>for Pneumatic Valves</i>		<i>for Pneumatic Valves</i>
Connection Type	W	W-Seal	W	W-Seal
Body Size	18	1.125"	18	1.125"
Flow Path		<i>Omit for HGSODV1 series</i>		<i>Omit for HGCVSE series</i>
Seat Material		PCTFE (standard)		Rubber (standard)
Grade	P	EP grade	P	EP grade

## HGSODV1 Diaphragm Valves

### HGS® Low Pressure Manual Diaphragm Valves (Shutoff Type)

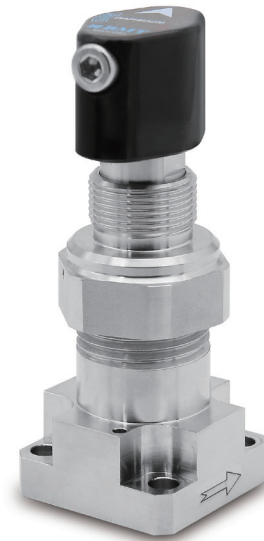

#### Specifications

Size	1.125"	1.5"
Cv Value	0.1 (Standard Type) / 0.2 (High-flow Type)	
Max. Working Pressure	1 MPa (145 psig)	
Working Temperature	PCTFE: -10 ~ 80°C (14 ~ 176°F) PFA: -10 ~ 150°C (14 ~ 302°F)	
Inboard Leak Test Rates (He) (Holding Time ≥ 15 sec.)	≤1x10 <sup>-9</sup> atm.cc/s	
Across the Seat Leak Test Rates (He) (Holding Time ≥ 15 sec.)	≤1x10 <sup>-9</sup> atm.cc/s	
Particle Inspection (EP Only) (0.1µm and Larger)	No Count	
Inner Surface Roughness	Ra ≤ 5 µin, Ry ≤ 0.7 µm	

#### Material

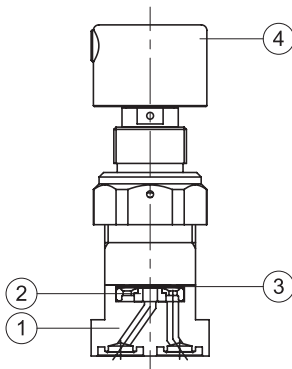

No.	Component	Material
1	Body	316L Stainless Steel VAR
2	Seat	PCTFE ( <i>standard</i> ) / PFA
3	Diaphragm	Ni-Co Alloy
4	Handle	ABS

#### NOTE:

- Dimensions and Drawings are for reference only and are subject to change without prior notice.
- Unless otherwise specified, all dimensions are in millimeters.
- HGS® : Trademark registered in Republic of Korea (as of April 2024)

Dimensions

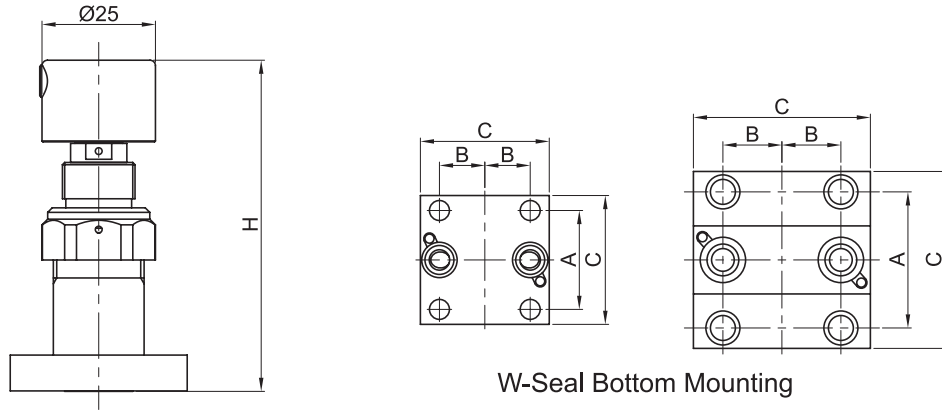

W-Seal Bottom Mounting

Body Size	Connection Type	Part No.	Dimensions (mm)			
			H	A	B	C
1.125"	W-Seal	DMHGSODV1-W18-P	73	21.8	10	28.4
		DMHGSODV1-W18-F-P				
1.5"	W-Seal	DMHGSODV1-W24-P	73	30	13	39
		DMHGSODV1-W24-F-P				

NOTE:  
 ·Dimensions and Drawings are for reference only and are subject to change without prior notice.  
 ·Unless otherwise specified, all dimensions are in millimeters.  
 ·HGS® : Trademark registered in Republic of Korea (as of April 2024)

# HGPDV1 Diaphragm Valves

## HGS® Low Pressure Pneumatic Diaphragm Valves



### Specifications

Size	1.125"	1.5"
Cv Value	0.1 (Standard Type) / 0.2 (High-flow Type)	
Max. Working Pressure	1 MPa (145 psig)	
Operating Pressure	0.4 ~ 0.6 MPa (58 ~ 87 psig)	
Working Temperature	PCTFE: -10 ~ 80°C (14 ~ 176°F) PFA: -10 ~ 150°C (14 ~ 302°F)	
Inboard Leak Test Rates (He) (Holding Time ≥ 15 sec.)	≤1x10 <sup>-9</sup> atm.cc/s	
Across the Seat Leak Test Rates (He) (Holding Time ≥ 15 sec.)	≤1x10 <sup>-9</sup> atm.cc/s	
Particle Inspection (EP Only) (0.1µm and Larger)	No Count	
Inner Surface Roughness	Ra ≤ 5 µin, Ry ≤ 0.7 µm	

### Material

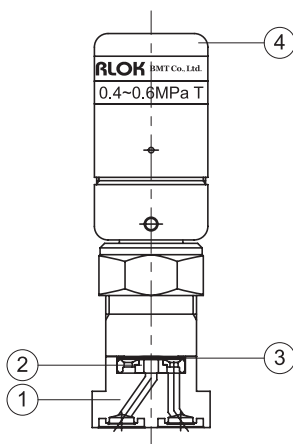

No.	Component	Material
1	Body	316L Stainless Steel VAR
2	Seat	PCTFE ( <i>standard</i> ) / PFA
3	Diaphragm	Ni-Co Alloy
4	Actuator	Aluminium

NOTE:  
 ·Dimensions and Drawings are for reference only and are subject to change without prior notice.  
 ·Unless otherwise specified, all dimensions are in millimeters.  
 ·HGS® : Trademark registered in Republic of Korea (as of April 2024)

Dimensions

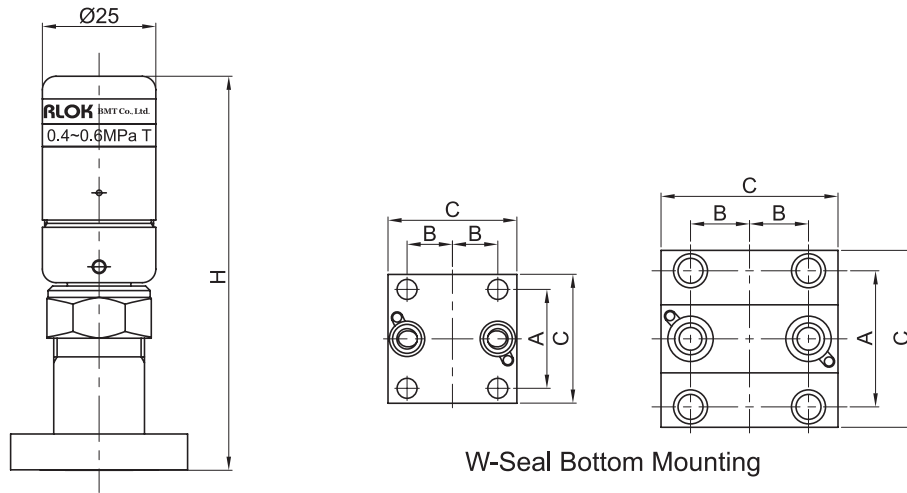

Body Size	Connection Type	Part No.	Dimensions (mm)			
			H	A	B	C
1.125"	W-Seal	DMHGPDV1C-W18-P	86	21.8	10	28.4
		DMHGPDV1C-W18-F-P				
1.5"	W-Seal	DMHGPDV1C-W24-P	88	30	13	39
		DMHGPDV1C-W24-F-P				

NOTE:  
 ·Dimensions and Drawings are for reference only and are subject to change without prior notice.  
 ·Unless otherwise specified, all dimensions are in millimeters.  
 ·HGS® : Trademark registered in Republic of Korea (as of April 2024)

## HGPBDV1 Diaphragm Valves

### HGS® Low Pressure Pneumatic Diaphragm Valves (Block)



#### Specifications

Size	1.125"	1.5"
Cv Value	0.1 (Standard Type) / 0.2 (High-flow Type)	
Max. Working Pressure	1 MPa (145 psig)	
Operating Pressure	0.4 ~ 0.6 MPa (58 ~ 87 psig)	
Working Temperature	PCTFE: -10 ~ 80°C (14 ~ 176°F) PFA: -10 ~ 150°C (14 ~ 302°F)	
Inboard Leak Test Rates (He) (Holding Time ≥ 15 sec.)	≤1x10 <sup>-9</sup> atm.cc/s	
Across the Seat Leak Test Rates (He) (Holding Time ≥ 15 sec.)	≤1x10 <sup>-9</sup> atm.cc/s	
Particle Inspection (EP Only) (0.1µm and Larger)	No Count	
Inner Surface Roughness	Ra ≤ 5 µin, Ry ≤ 0.7 µm	

#### Material

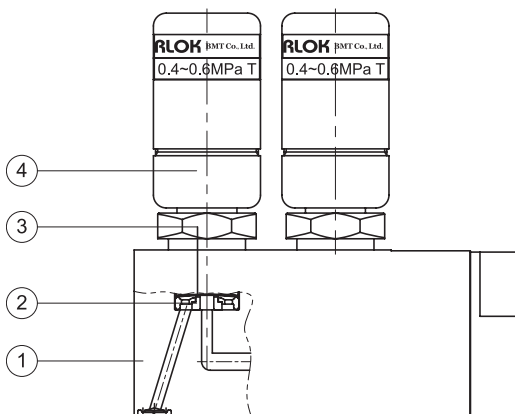

No.	Component	Material
1	Body	316L Stainless Steel VAR
2	Seat	PCTFE ( <i>standard</i> ) / PFA
3	Diaphragm	Ni-Co Alloy
4	Actuator	Aluminium

#### NOTE:

- Dimensions and Drawings are for reference only and are subject to change without prior notice.
- Unless otherwise specified, all dimensions are in millimeters.
- HGS® : Trademark registered in Republic of Korea (as of April 2024)

Dimensions

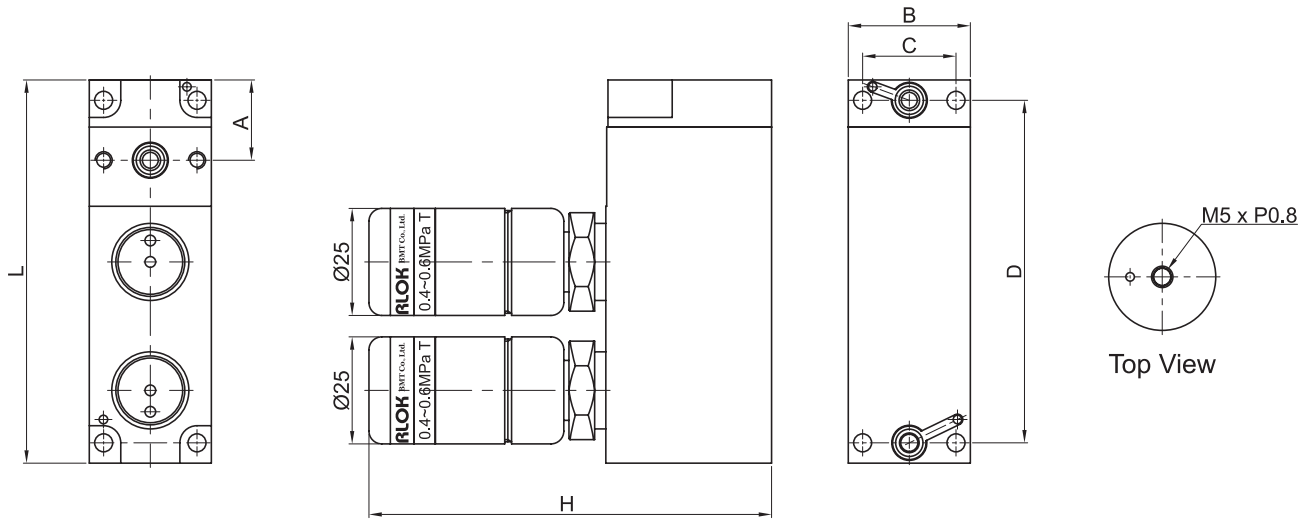

Body Size	Connection Type	Part No.	Dimensions (mm)					
			L	H	A	B	C	D
1.125"	W-Seal	DMHGPBDV1C-W18-1F23-P	89.5	94	18.75	28.5	21.8	80
		DMHGPBDV1C-W18-1F23-F-P						
1.5"	W-Seal	DMHGPBDV1C-W24-1F23-P	93	100	24	39	30	78.5
		DMHGPBDV1C-W24-1F23-F-P						

NOTE:  
 ·Dimensions and Drawings are for reference only and are subject to change without prior notice.  
 ·Unless otherwise specified, all dimensions are in millimeters.  
 ·HGS® : Trademark registered in Republic of Korea (as of April 2024)

# HGCVSE Check Valves

## HGS® Check Valves (Seal Type)



### Specifications

Size	1.125"
Cv Value	0.25
Max. Working Pressure	1 MPa (145 psig)
Working Temperature	-10 ~ 80°C (14 ~ 176°F)
Cracking Pressure	2.3 kPa
Inboard Leak Test Rates (He) (Holding Time ≥ 15 sec.)	≤1x10 <sup>-9</sup> atm.cc/s
Particle Inspection (EP Only) (0.1µm and Larger)	No Count
Inner Surface Roughness	Ra ≤ 5 µin, Ry ≤ 0.7 µm

### Material

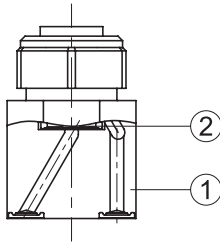

No.	Component	Material
1	Body	316L Stainless Steel VAR
2	Seat	NBR (standard) FKM FFKM

### Dimensions

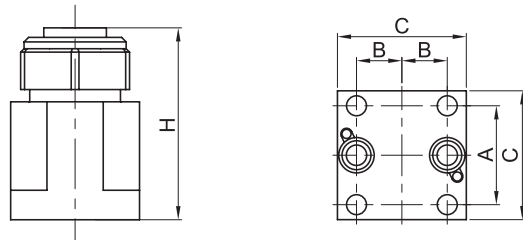

W-Seal Bottom Mounting

Body Size	Connection Type	Part No.	Dimensions (mm)			
			H	A	B	C
1.125"	W-Seal	DMHGCVSE-W18-P	42.3	21.8	10	28.4

NOTE:  
 ·Dimensions and Drawings are for reference only and are subject to change without prior notice.  
 ·Unless otherwise specified, all dimensions are in millimeters.  
 ·HGS® : Trademark registered in Republic of Korea (as of April 2024)

## HGCVSP Check Valves

### HGS® Check Valves (Spring Type)



#### Specifications

Size	1.125"
Cv Value	0.25
Max. Working Pressure	1 MPa (145 psig)
Working Temperature	-10 ~ 80°C (14 ~ 176°F)
Cracking Pressure	2.3 kPa
Inboard Leak Test Rates (He) (Holding Time ≥ 15 sec.)	≤1x10 <sup>-9</sup> atm.cc/s
Particle Inspection (EP Only) (0.1µm and Larger)	No Count
Inner Surface Roughness	Ra ≤ 5 µin, Ry ≤ 0.7 µm

#### Material

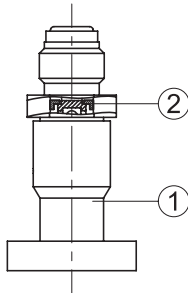

No.	Component	Material
1	Body	316L Stainless Steel VAR
2	Seat	NBR (standard) FKM FFKM

#### Dimensions

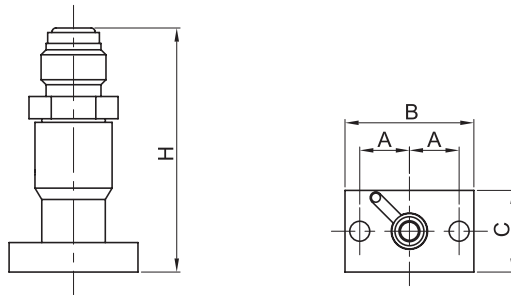

W-Seal Bottom Mounting

Body Size	Connection Type	Part No.	Dimensions (mm)			
			H	A	B	C
1.125"	W-Seal	DMHGCVSP-W18-P	54	10.9	28.4	18

**NOTE:**

·Dimensions and Drawings are for reference only and are subject to change without prior notice.

·Unless otherwise specified, all dimensions are in millimeters.

·HGS® : Trademark registered in Republic of Korea (as of April 2024)

# HGS® Regulators

## Ordering Information

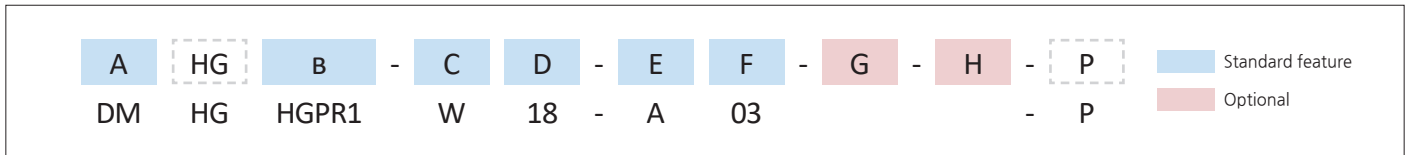

A	Materials	
DM	316L Stainless Steel	VAR
HM	Hastelloy	

B	Product Series	
HGPR1	Regulator	
HGPRL1	Regulator (Tied Type)	

C	Connection Type	
W	W-Seal	

D	Body Size	
	Designator	Nominal Size
	18	1.125"
	24	1.5"

E	Maximum Inlet Pressure	
A	150	psig

F	Outlet Pressure	
03	30	psig
06	60	psig
10	100	psig

G	Seat Material	
PCTFE is standard. No part designator needed.		
PA	PFA	
PI	PI	

H	Flow Rate	
Cv 0.04 is standard. No part designator needed.		
F	High Flow Type (Cv 0.08)	

## Part Number Examples

	DMHGPR1-W18-A03-P		DMHGPR1-W24-A06-P	
Material	DM	316L Stainless Steel VAR	DM	316L Stainless Steel VAR
Product Series	HGPR1	HGPR1 series	HGPRL1	HGPRL1 series
Connection Type	W	W-SEAL	W	W-SEAL
Body Size	18	1.125"	24	1.5"
Max. Inlet Pressure	A	150 psig	A	150 psig
Outlet Pressure	03	30 psig	06	60 psig
Seat Material	PCTFE (standard)		PCTFE (standard)	
Flow Rate	0.04 (standard)		0.04 (standard)	
Grade	P	EP grade	P	EP grade

## HGPR1 Regulators

### HGS® Regulators (Standard Type)



#### Specifications

Size	1.125"	1.5"
Cv Value	0.04 (Standard Type) / 0.08 (High-flow Type)	
Max. Inlet Pressure	150 psig	
Outlet Pressure Range	3~30, 3~60, 3~100 psig (0.2~2.1, 0.2~4.1, 0.2~6.9 bar)	
Design Proof Pressure	150% of Maximum rated pressure	
Max. Working Temperature	-40 to 70°C (-40 to 158°F)	
Inboard Leakage Allowance (He) (Holding Time ≥ 15 sec.)	≤1x10 <sup>-9</sup> atm.cc/s	
Particle Inspection (EP Only) (0.1µm and Larger)	No Count	
Inner Surface Roughness	Ra ≤ 5 µin, Ry ≤ 0.7 µm	

#### Material

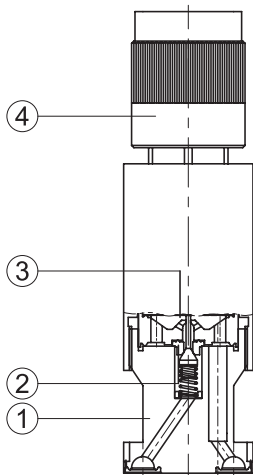

No.	Component	Material
1	Body	316L Stainless Steel VAR
2	Seat	PCTFE ( <i>standard</i> )
3	Diaphragm	Hastelloy
4	Handle	ABS

NOTE:

·Dimensions and Drawings are for reference only and are subject to change without prior notice.  
 ·Unless otherwise specified, all dimensions are in millimeters.

·HGS® : Trademark registered in Republic of Korea (as of April 2024)

Flow Charts

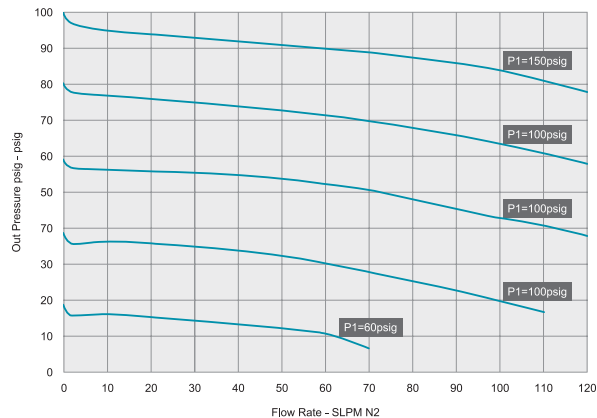

Dimensions

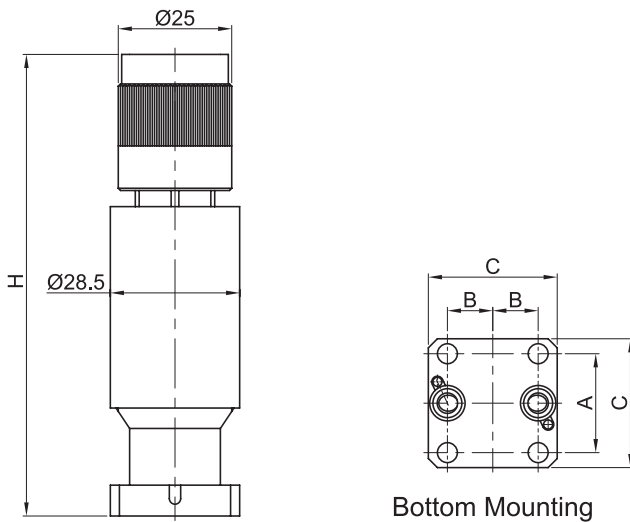

Bottom Mounting

Body Size	Connection Type	Part No.	Dimensions (mm)			
			H	A	B	C
1.125"	W-Seal	DMHGPR1-W18-A03-P	108.5	21.8	10	28.4
		DMHGPR1-W18-A03-F-P				
1.5"	W-Seal	DMHGPR1-W24-A03-P	108.5	30	13	39
		DMHGPR1-W24-A03-F-P				

NOTE:  
 ·Dimensions and Drawings are for reference only and are subject to change without prior notice.  
 ·Unless otherwise specified, all dimensions are in millimeters.  
 ·HGS® : Trademark registered in Republic of Korea (as of April 2024)

## HGPRL1 Regulators

### HGS® Regulators (Tied Type)



#### Specifications

Size	1.125"	1.5"
Cv Value	0.04 (Standard Type) / 0.08 (High-flow Type)	
Max. Inlet Pressure	150 psig	
Outlet Pressure Range	3~30, 3~60, 3~100 psig (0.2~2.1, 0.2~4.1, 0.2~6.9 bar)	
Design Proof Pressure	150% of Maximum rated pressure	
Max. Working Temperature	-40 to 70°C (-40 to 158°F)	
Inboard Leakage Allowance (He) (Holding Time ≥ 15 sec.)	≤1x10 <sup>-9</sup> atm.cc/s	
Particle Inspection (EP Only) (0.1µm and Larger)	No Count	
Inner Surface Roughness	Ra ≤ 5 µin, Ry ≤ 0.7 µm	

#### Material

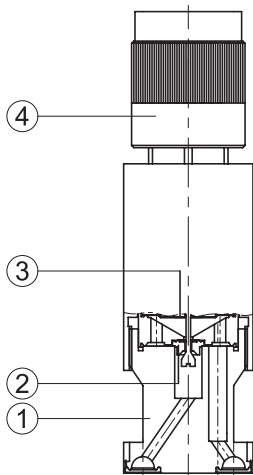

No.	Component	Material
1	Body	316L Stainless Steel VAR
2	Seat	PCTFE ( <i>standard</i> )
3	Diaphragm	Hastelloy
4	Handle	ABS

NOTE:

·Dimensions and Drawings are for reference only and are subject to change without prior notice.  
 ·Unless otherwise specified, all dimensions are in millimeters.

·HGS® : Trademark registered in Republic of Korea (as of April 2024)

Flow Charts

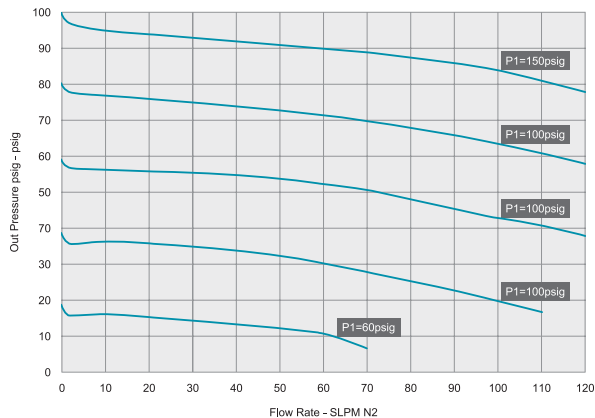

Dimensions

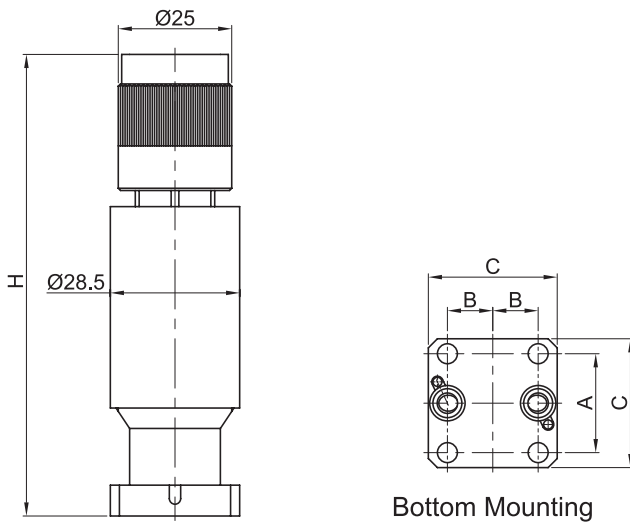

Bottom Mounting

Body Size	Connection Type	Part No.	Dimensions (mm)			
			H	A	B	C
1.125"	W-Seal	DMHGPRL1-W18-A03-P	108.5	21.8	10	28.4
		DMHGPRL1-W18-A03-F-P				
1.5"	W-Seal	DMHGPRL1-W24-A03-P	108.5	30	13	39
		DMHGPRL1-W24-A03-F-P				

NOTE:  
 ·Dimensions and Drawings are for reference only and are subject to change without prior notice.  
 ·Unless otherwise specified, all dimensions are in millimeters.  
 ·HGS® : Trademark registered in Republic of Korea (as of April 2024)

# HGS® Filters

## Ordering Information

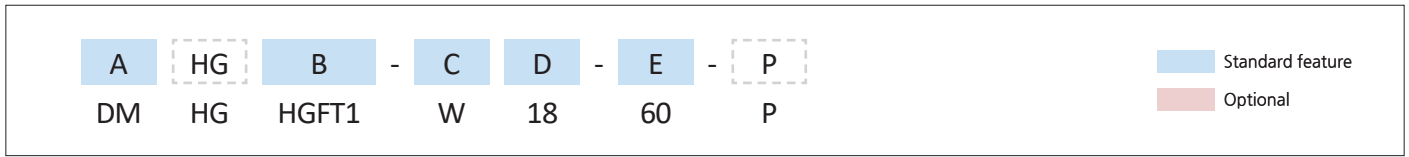

A	Body Materials	
DM	316L Stainless Steel VAR	
HM	Hastelloy C-22	

B	Element Series	
HGFT1	Stainless Steel Element	
HGFT2	HASTELLOY C-22 Element	

C	Connection Type	
W	W-Seal	

D	Body Size	
	Designator	Nominal Size
	18	1.125"
	24	1.5"

E	Rated Flow (SLPM)	
30	30 SLPM	
60	60 SLPM	
120	120 SLPM	

## Part Number Examples

	DMHGFT1-W18-60-P		HMHGFT2-W18-120-P	
Material	DM	316L Stainless Steel VAR	HM	Hastelloy C-22
Product Series	HGFT1	HGFT1 series	HGFT2	HGFT2 series
Connection Type	W	W-Seal	W	W-Seal
Body Size	18	1.125"	18	1.125"
Rated Flow	60	60 SLPM	120	120 SLPM
Grade	P	EP grade	P	EP grade

# HGFT1 Filters

## HGS® Filters



### Specifications

Size	1.125"	1.5"
Max. Inlet pressure	0.98Mpa (10kgf/m <sup>2</sup> ) at 20°C	
Max. Differential pressure	0.7Mpa (7kgf/m <sup>2</sup> ) at 20°C	
Max. Working Temp.	460°C	
Removal rating	≥0.002μm	
Retention	Greater than 99.9999999% Removal of all particles down to 0.002μm	
Rated Flow @10°	30, 60, 120 SLPM	
Helium leak rating	≤1x10 <sup>-9</sup> atm.cc/s	
Inner Surface Roughness	Ra ≤ 5 μin, Ry ≤ 0.7 μm	

### Material

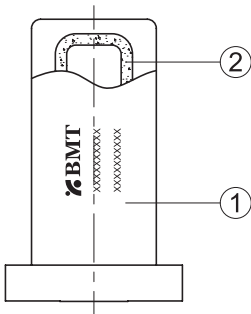

No.	Component	Material
1	Body	316L Stainless Steel VAR
2	Element	316L Stainless Steel VAR

NOTE:  
 ·Dimensions and Drawings are for reference only and are subject to change without prior notice.  
 ·Unless otherwise specified, all dimensions are in millimeters.  
 ·HGS® : Trademark registered in Republic of Korea (as of April 2024)

Flow Charts

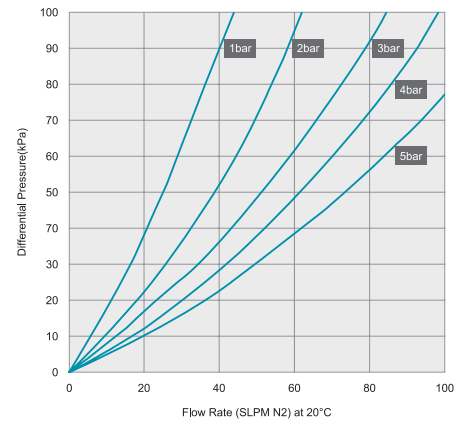
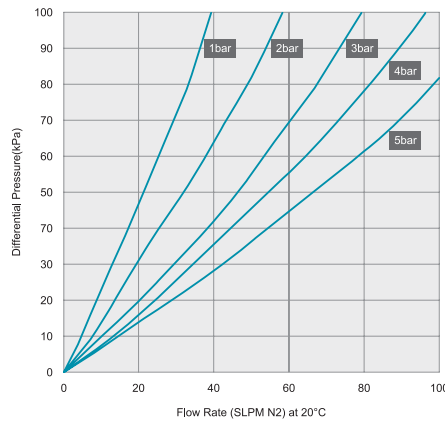
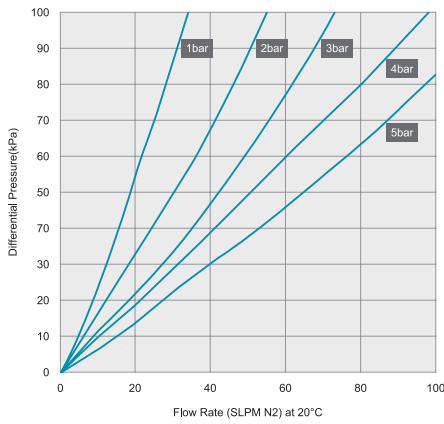

Dimensions

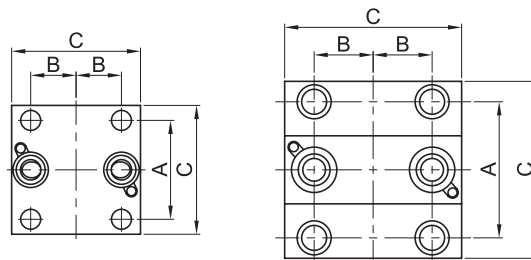
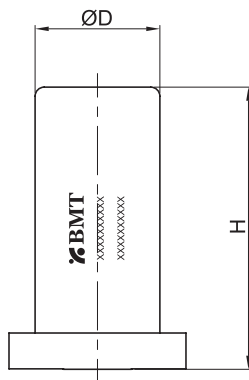

W-Seal Bottom Mounting

Body Size	Connection Type	Part No.	Dimensions (mm)				
			H	A	B	C	D
1.125"	W-Seal	DMHGFT1-W18-30-P	45.5				
		DMHGFT1-W18-60-P	58.5	21.8	10	28.4	21.5
		DMHGFT1-W18-120-P	92				
1.5"	W-Seal	DMHGFT1-W24-60-P	62				
		DMHGFT1-W24-120-P	96	30	13	39	27.5

NOTE:  
 ·Dimensions and Drawings are for reference only and are subject to change without prior notice.  
 ·Unless otherwise specified, all dimensions are in millimeters.

·HGS® : Trademark registered in Republic of Korea (as of April 2024)

## HGFT2 Filters

### HGS® Filters



### Specifications

Size	1.125"	1.5"
Max. Inlet pressure	0.98Mpa (10kgf/m <sup>2</sup> ) at 20°C	
Max. Differential pressure	0.7Mpa (7kgf/m <sup>2</sup> ) at 20°C	
Max. Working Temp.	460°C	
Removal rating	≥0.002μm	
Retention	Greater than 99.9999999% Removal of all particles down to 0.002μm	
Rated Flow @10 <sup>9</sup>	30, 60, 120 SLPM	
Helium leak rating	≤1x10 <sup>-9</sup> atm.cc/s	
Inner Surface Roughness	Ra ≤ 5 μin, Ry ≤ 0.7 μm	

### Material

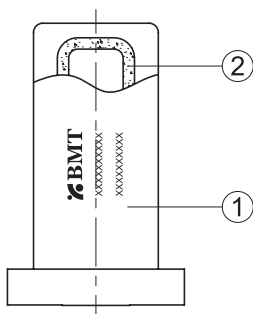

No.	Component	Material
1	Body	Hastelloy C-22
2	Element	Hastelloy C-22

**NOTE:**

·Dimensions and Drawings are for reference only and are subject to change without prior notice.

·Unless otherwise specified, all dimensions are in millimeters.

·HGS® : Trademark registered in Republic of Korea (as of April 2024)

Flow Charts

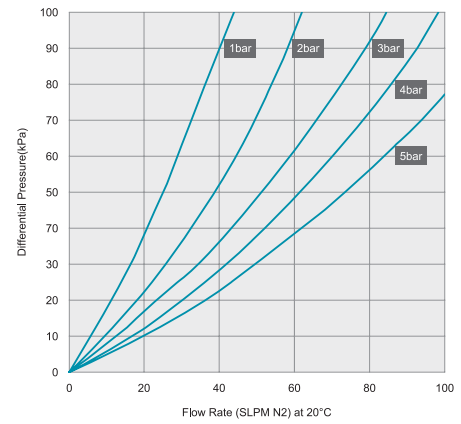
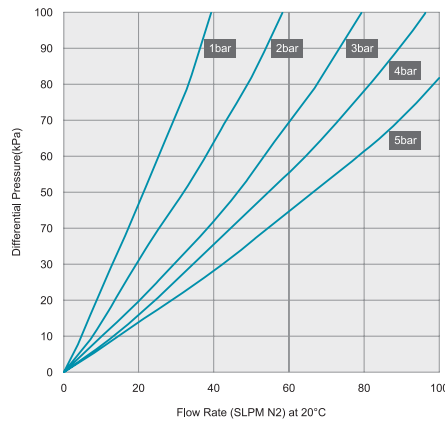
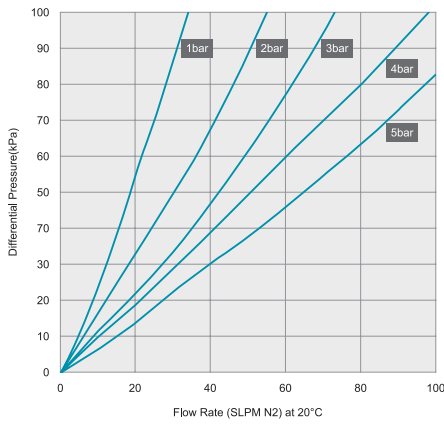

Dimensions

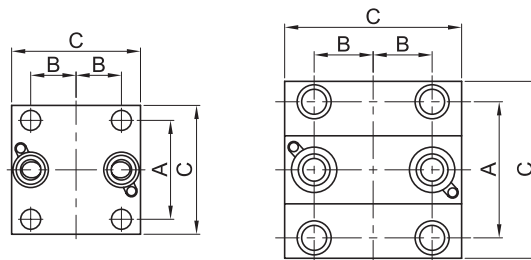
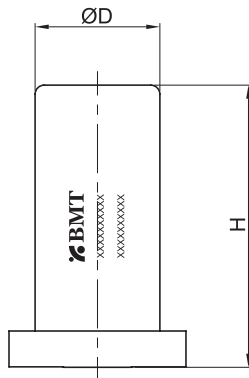

W-Seal Bottom Mounting

Body Size	Connection Type	Part No.	Dimensions (mm)				
			H	A	B	C	D
1.125"	W-Seal	HMHGFT2-W18-30-P	45.5				
		HMHGFT2-W18-60-P	58.5	21.8	10	28.4	21.5
		HMHGFT2-W18-120-P	92				
1.5"	W-Seal	HMHGFT2-W24-60-P	62				
		HMHGFT2-W24-120-P	96	30	13	39	27.5

NOTE:  
 ·Dimensions and Drawings are for reference only and are subject to change without prior notice.  
 ·Unless otherwise specified, all dimensions are in millimeters.

# HGS® Base Block & Gasket

## Ordering Information

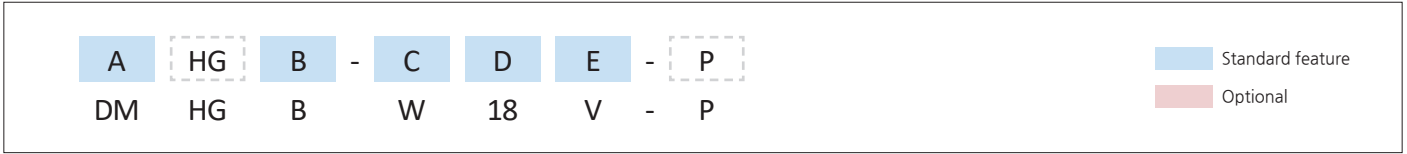

A	Materials	
DM	316L Stainless Steel VAR	

B	Product Series	
B	Base Block	
GK	Gasket	

C	Connection Type	
W	W-Seal	

D	Body Size	
	Designator	Nominal Size
	18	1.125"
	24	1.5"

E	Body Type (for Base Block)	
V	V Type	
WL	WL Type	
L	L Type	

## Part Number Examples

	DMHGB-W18V-P		DMHGB-W24V-P	
Material	DM	316L Stainless Steel VAR	DM	316L Stainless Steel VAR
Product Series	B	Base Block series	B	Base Block series
Connection Type	W	W-Seal	W	W-Seal
Body Size	18	1.125"	24	1.5"
Body Type	V	V Type	V	V Type
Grade	P	EP grade	P	EP grade

# HGS® Base Block

## V-Type

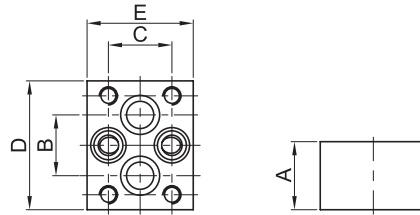

Body Size	Connection Type	Part No.	Dimensions (mm)					Material
			A	B	C	D	E	
1.125"	W-Seal	DMHGB-W18V-P	15	13.4	14	28.4	23.4	316L Stainless Steel VAR
1.5"	W-Seal	DMHGB-W24V-P	20	16	20.5	39	32.5	316L Stainless Steel VAR

## WL-Type

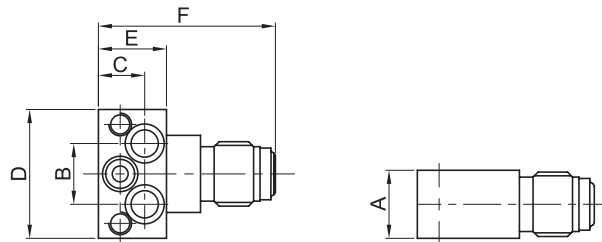
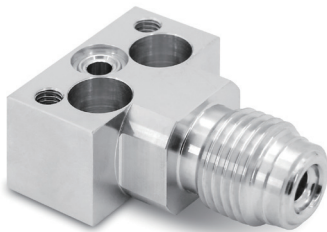

Body Size	Connection Type	Part No.	Dimensions (mm)						Material
			A	B	C	D	E	F	
1.125"	W-Seal	DMHGB-W18WL-P	15	13.4	10.2	28.4	15	39	316L Stainless Steel VAR
1.5"	W-Seal	DMHGB-W24WL-P	20	16	5	39	12.5	37	316L Stainless Steel VAR

NOTE:  
 ·Dimensions and Drawings are for reference only and are subject to change without prior notice.  
 ·Unless otherwise specified, all dimensions are in millimeters.  
 ·HGS® : Trademark registered in Republic of Korea (as of April 2024)

## L-Type

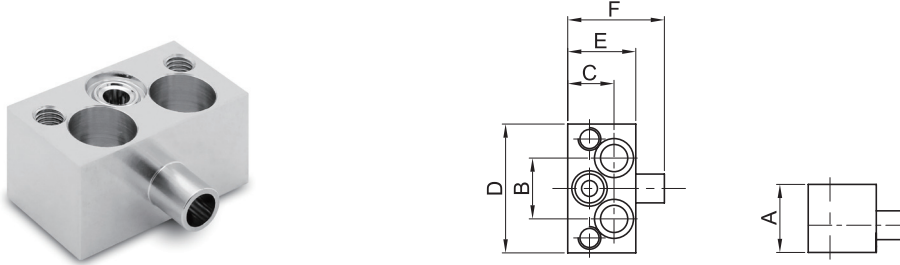

Body Size	Connection Type	Part No.	Dimensions (mm)						Material
			A	B	C	D	E	F	
1.125"	W-Seal	DMHGB-W18L-P	15	13.4	10.2	28.4	15	21.3	316L Stainless Steel VAR
1.5"	W-Seal	DMHGB-W24L-P	20	16	5	39	12.5	18.8	316L Stainless Steel VAR

## HGS® Gasket

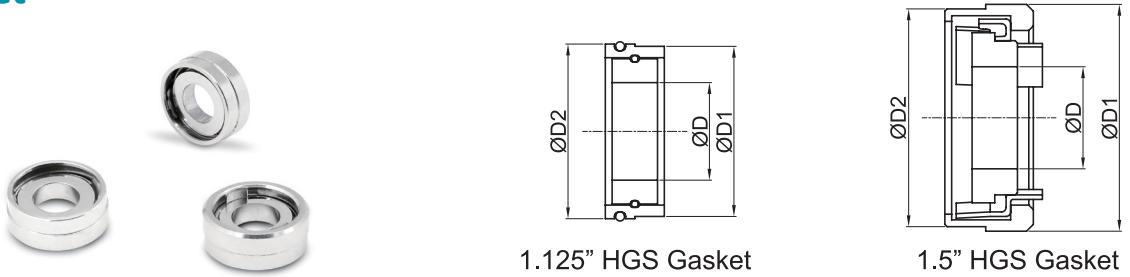

1.125" HGS Gasket

1.5" HGS Gasket

Body Size	Connection Type	Part No.	Dimensions (mm)				Material
			ØD	ØD1	ØD2	L	
1.125"	W-Seal	DMHGGK-W18-P	4.3	7.5	7.7	2.6	316L Stainless Steel VAR
1.5"	W-Seal	DMHGGK-W24-P	4.5	10	9.6	3.9	316L Stainless Steel VAR

NOTE:  
 ·Dimensions and Drawings are for reference only and are subject to change without prior notice.  
 ·Unless otherwise specified, all dimensions are in millimeters.  
 ·HGS® : Trademark registered in Republic of Korea (as of April 2024)



### 1. Flow Design

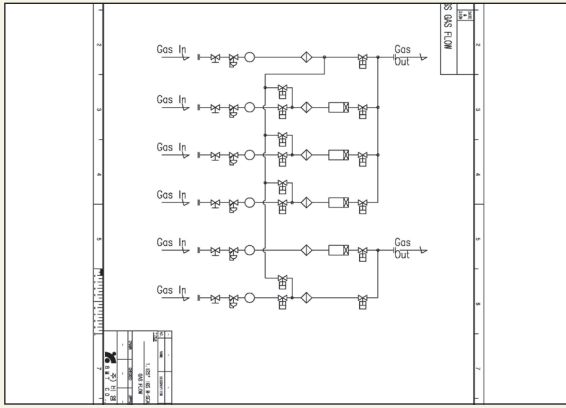

### 2. Drawing Create

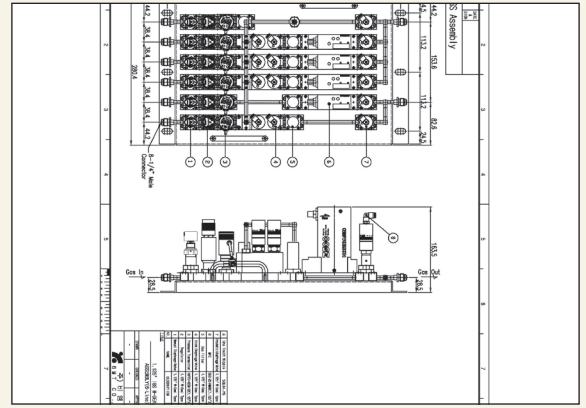

# HGS DESIGN & ASSEMBLY



1.125" HGS Assembly

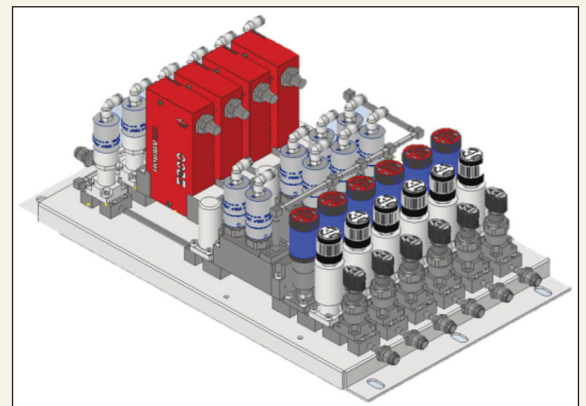

5. HGS Gas Panel Assembly





### 3. Base Block Assembly

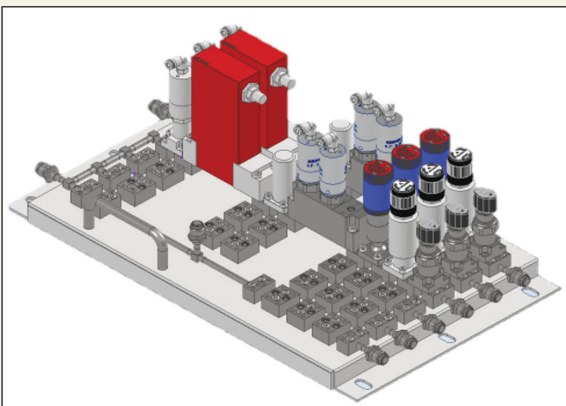
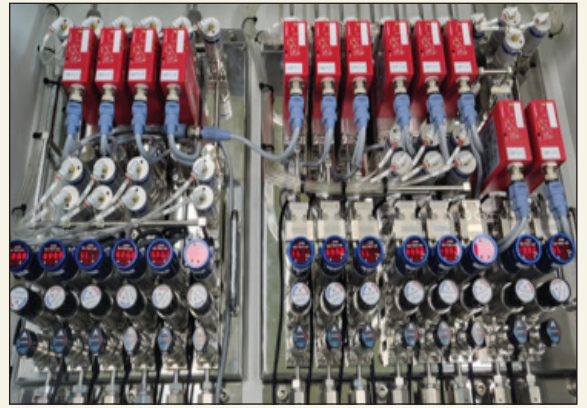
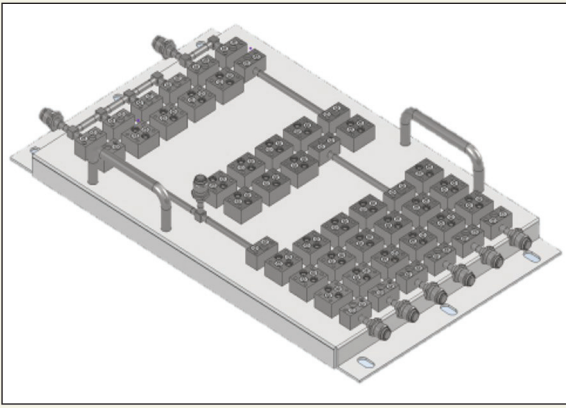

### 4. Mounting Component

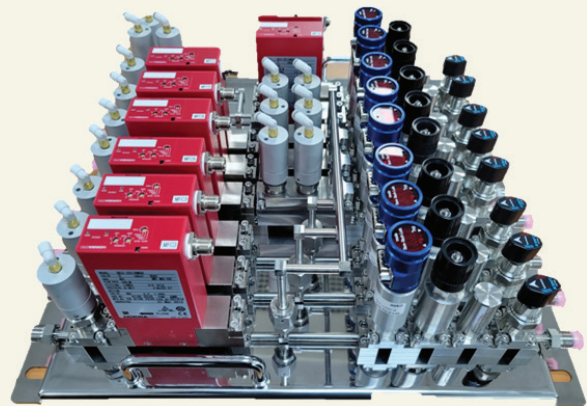
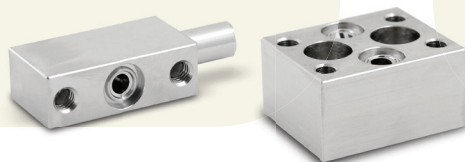

# BMT Co., Ltd.

## Headquarters

(46031) 부산시 기장군 장안읍 신소재산단2로 17 (반룡리)

17, Sinsojaesandan 2-ro, Jangan-eup, Gijang-gun, Busan, 46031 South Korea

TEL: +82 51 780 5000 FAX: +82 51 780 5100

E-mail: superlok@superlok.com

WEB: www.superlok.com

## Fittings & Valves

### Industrial

Instrumentation Tube Fittings

i-Fitting®

Ball/Plug Valves

Double Block & Bleed Valves

Manifold/Gauge Valves

Globe/Needle Valves

Cryogenic Valves

Check/Relief/Excess Flow Valves

Medium/High Pressure Fittings & Valves

Eco-fuel Conversion and Supply Units

### Ultra High Purity

HGB® (High-integrated Gas Box)

HGS® (High-integrated Gas System)

Weld & Metal Face Seal Fittings

Bend Fittings

Diaphragm Valves

Bellows Valves

Check Valves

Clean Ball Valves

Regulators

Gas Filters

HGB® : Trademark registered in Republic of Korea, Japan and United States (as of August 2025)

HGS® : Trademark registered in Republic of Korea, Japan and United States (as of May 2025)

## Electric & Energy

Metal Clad Switchgear (MCSG)

Compact Switchboard

Motor Control Center (MCC)

Smart Distribution Board

Energy Management System (EMS)