

MFDV2 Diaphragm Valves

Medium Pressure Manual Diaphragm Valves (High Flow Type)

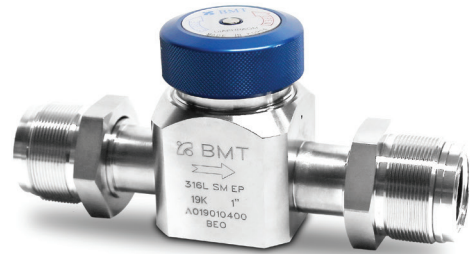

Specifications

Size	1/2"	1
Cv Value	2.8	3.5
Orifice Size	10.2 mm	15.5 mm
Max. Working Pressure	19 bar (275 psig)	
Working Temperature	-10 ~ 80°C (14 ~ 176°F)	
Inboard Leak Test Rates (He) (Holding Time ≥ 15 sec.)	≤1x10 ⁻⁹ atm.cc/s	
Across the Seat Leak Test Rates (He) (Holding Time ≥ 15 sec.)	≤1x10 ⁻⁹ atm.cc/s	
Particle Inspection (EP Only) (0.1µm and Larger)	No Count	
Inner Surface Roughness	MP: Ra ≤ 20 µin, Ry ≤ 6 µm BA: Ra ≤ 10 µin, Ry ≤ 3 µm EP: Ra ≤ 5 µin, Ry ≤ 0.7 µm	

Material

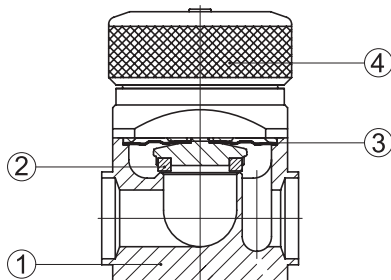

No.	Component	Material
1	Body	316L Stainless Steel
		316L Stainless Steel VAR
		304 Stainless Steel
2	Seat	PCTFE (<i>standard</i>)
3	Diaphragm	316L Stainless Steel
4	Handle	Aluminium

NOTE:

·Dimensions and Drawings are for reference only and are subject to change without prior notice.
·Unless otherwise specified, all dimensions are in millimeters.

Dimensions

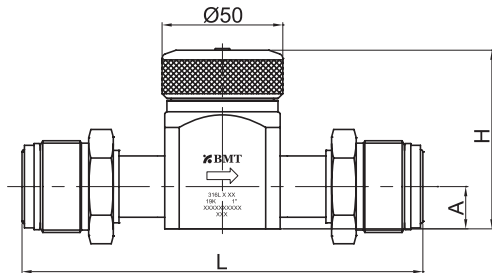

Male BVC

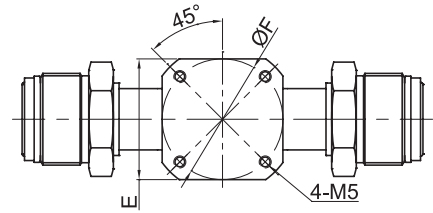
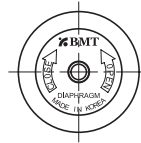

Bottom Mounting

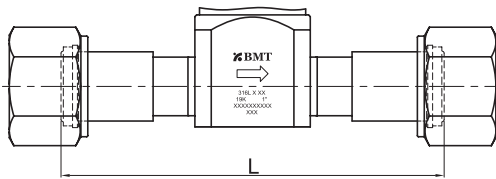

Female BVC

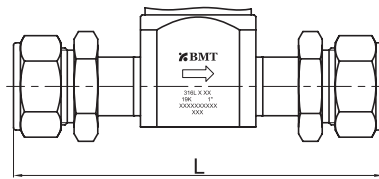

SUPERLOK Tube Fitting

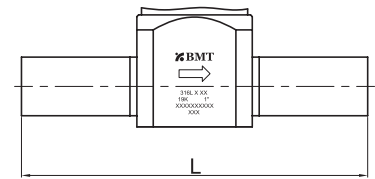

Tube Butt Weld

End Connection	Part No.	Dimensions (mm)				
		L	H	A	E	F (Φ)
Male BVC	SMMFDV2-VM16	166	74	17.5	50	50
Female BVC	SMMFDV2-VF16	166	74	17.5	50	50
SUPERLOK Tube Fitting	SMMFDV2-S16	160	74	17.5	50	50
Tube Butt Weld	SMMFDV2-TW16	150	74	17.5	50	50
Male BVC	SMMFDV2-VM8	138.7	69.5	16	50	50
Female BVC	SMMFDV2-VF8	138.7	69.5	16	50	50
SUPERLOK Tube Fitting	SMMFDV2-S8	136.2	69.5	16	50	50
Tube Butt Weld	SMMFDV2-TW8	150	69.5	16	50	50

NOTE:
 ·Dimensions and Drawings are for reference only and are subject to change without prior notice.
 ·Unless otherwise specified, all dimensions are in millimeters.

Ordering Information

Medium Pressure Manual Diaphragm Valves (High Flow Type)
 *Additional configurations available upon request.

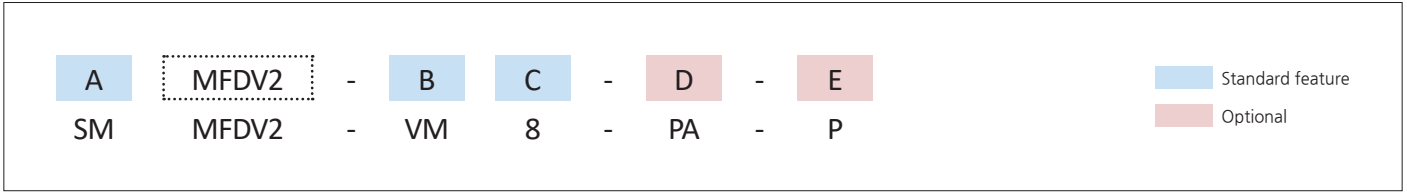

A	Materials	
SM	316L Stainless Steel	
DM	316L Stainless Steel VAR	
4SS	304 Stainless Steel	

E	Seat Material	
PTFE is standard. No part designator needed.		
PA	PFA	
PI	Polyimide	

B	Connection Type	
VM	Male BVC (BMT Vacuum Coupling)	
VF	Female BVC (BMT Vacuum Coupling)	
S	SUPERLOK Tube Fitting	
TW	Butt Weld	
VMXVF	In Male-Out Female	

F	Wetted Surface Grade	
BA is standard. No part designator needed.		
P	EP	
AP	AP	

C	Connection Size			
	Designator	Nominal Size	Outside Diameter	Wall Thickness
	8	1/2 in.	12.7 mm	1.24 mm
	16	1 in.	25.4 mm	1.65 mm

Part Number Examples

	SMMFDV2-VM16		DMMFDV2-VF16-P	
Material	SM	316L Stainless Steel	DM	316L Stainless Steel VAR
Series	MFDV2	MFDV2 series	MFDV2	MFDV2 series
Operation Method		<i>Omit for Manual Valves</i>		<i>Omit for Manual Valves</i>
Connection Type	VM	BVC Male	VF	BVC Female
Connection Size	16	1"	16	1"
Seat Material		PCTFE (standard)		PCTFE (standard)
Grade		BA grade (Standard)	P	EP grade

NOTE:
 ·Dimensions and Drawings are for reference only and are subject to change without prior notice.
 ·Unless otherwise specified, all dimensions are in millimeters.